



▼ **Over 330 Clarifier installations in 3 continents**



- ▼ With over 60 years of design and commissioning expertise, you can be assured that your Hydroflux Epco clarifier will perform consistently with a long service life.

Hydroflux Epco clarifiers have been in operation since the late 1960's, in municipal water and wastewater treatment plants, industrial and mining applications.

## Design Configurations

▼ The HiFlow™ Lamella clarifier range includes the following configurations:

- Free standing modular units
- Concrete tank
- LogMax® Log spiral scraper mechanisms
- VeeMax® Chevron type fixed scrapers



**HYDROFLUX**  
epco

## Key Features



Free Standing Design

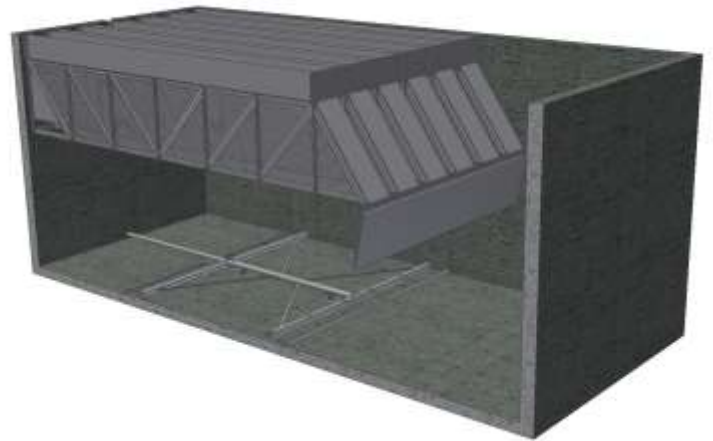

Concrete Tank Design

- ▶ High effective surface area
- ▶ Non-clog Lamella plate configuration
- ▶ Robust construction with heavy duty design
- ▶ Extensive design expertise with over 330 clarifier installations in 3 continents
- ▶ No scouring of sludge blanket
- ▶ Reliable heavy duty scraper designs for all mechanical scraper systems



## HiFlow™ Lamella For Raw Water Treatment



## Applications

### ▼ Municipal Sewage Treatment

- Primary clarification
- Secondary clarification
- Tertiary clarification

### ▼ Municipal Water Treatment

- River water clarification
- Backwash water recovery
- Sludge thickening
- Lime softening

### ▼ Seawater Desalination

- Backwash water recovery
- Lime softening

### ▼ Industrial and Mining

- Primary solids and precipitate removal
- Secondary clarification
- Tertiary clarification
- Raw water clarification



## System components

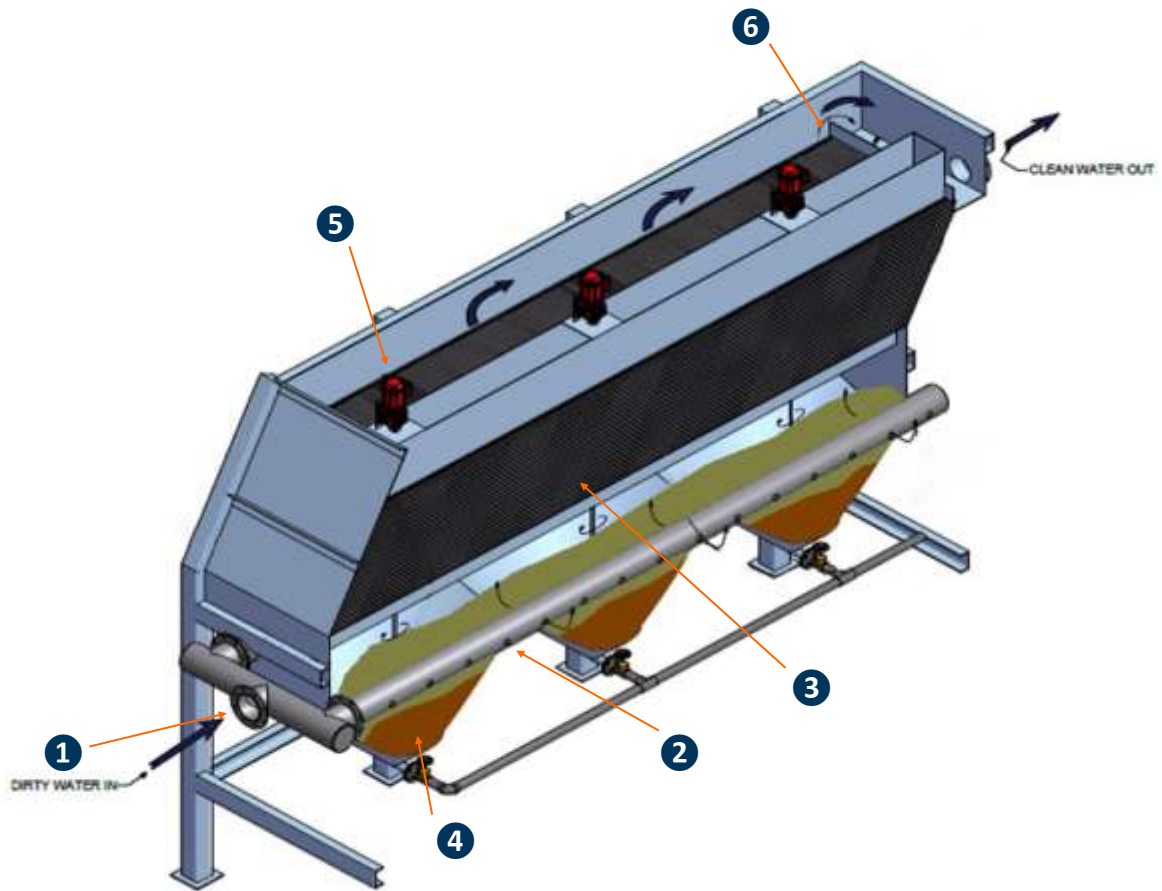

### 1 Inlet

Low turbulent entry feed pipe manifold

### 2 Feed Distribution

Distribution of feed along the full surface area

### 3 HiFlow® Plate Pack

Inclined plate packs with high projected surface area

### 4 Sludge Hopper

Integrated sludge hoppers for optimal solids concentration

### 5 Sludge Removal Scrapers

For efficient settled sludge removal (optional feature for viscous sludge types)

### 6 Weir Box

Combination of longitudinal and discharge weir box for clarified water removal



## Sludge Removal

### LOGMAX®

Logarithmic sludge plow designed for collection of lighter suspended sludges. Effective logarithmic angle range of between  $15^{\circ}$  and  $45^{\circ}$  and can travel at tip speeds up to 10m per minute.



### VEEMAX®

Chevron pattern sludge plow designed for heavy, relatively viscous, sludges. The VeeMax® sludge plow can be readily adapted to sludge thickening with the addition of the picket fence module.



**HYDROFLUX**  
epco



## Build Specification

▼ In general Hydroflux Epco Lamella clarifiers are fabricated with wetted parts from stainless steel, and the bridge and general fabrication steel work above water line in grade 250 mild steel epoxy coated.

The following table summarises the major components and their most common material selection. Variations on the material specifications can be made, please consult Hydroflux Epco for further detail.



SECTION	SPECIFICATION
Main Tank	Painted mild steel
Lamella Plates	304/316 Stainless Steel
Scraper System	Stainless steel 304/316
Squeegees	Neoprene
V-Notch weirs and baffles	Stainless steel 304/316

# Hydroflux Epco Pty Ltd

## Australia and Australasia

### Head Office:

Level 26, 44 Market Street  
Sydney NSW 2000 Australia

### Victorian Office:

84 Hotham St. Preston  
VIC 3072 Australia

### Sutherland Engineering Office:

3-5 Stapleton Ave.  
Sutherland NSW 2232 Australia

### Queensland Office:

1 Westlink Court  
Darra QLD 4076

**Int:** +61 2 9089 8833

**Aus:** 1300 417 697

[info@hydrofluxepco.com.au](mailto:info@hydrofluxepco.com.au)

[www.hydrofluxepco.com.au](http://www.hydrofluxepco.com.au)

## New Zealand

### Head Office:

Level 26, PwC Tower  
188 Quay St  
Auckland 1010, New Zealand

**Int:** +64 9 352 2052

**NZ:** 09 352 2052

[info@hydroflux.nz](mailto:info@hydroflux.nz)

[www.hydroflux.nz](http://www.hydroflux.nz)

## Fiji and Pacific Islands

### Head Office:

Suva Business Centre  
217 Victoria Parade  
Suva, Fiji

**Int:** +679 773 6950

**Fiji:** 773 6950

[info@hydroflux.com.fj](mailto:info@hydroflux.com.fj)

[www.hydroflux.com.fj](http://www.hydroflux.com.fj)

## United Kingdom and Europe

### Head Office:

1000 Lakeside North Harbour Western Road  
Portsmouth PO6 3EZ

**Int:** +44 23 9270 4087

**UK:** 0239 270 4087

[info@hydroflux.uk](mailto:info@hydroflux.uk)

[www.hydroflux.uk](http://www.hydroflux.uk)

Hydroflux EPCO is GRS Certified to the following standards

### OHSAS 18001 & AS/NZS 4801 SAFETY MANAGEMENT SYSTEM



Certificate Number: 47718001610007

Certificate Number: 4774801610007

### ISO 14001 ENVIRONMENTAL MANAGEMENT SYSTEM



Certificate Number: 47714001610007

### ISO 9001 QUALITY MANAGEMENT SYSTEM



Certificate Number: 4779001610007